

# DELFL 165/6 PP EN54

## In-ceiling 6 Watt Loudspeaker



### Main features

- Robust industrial technology
- Sturdy and robust design
- Enclosed housing
- Excellent speech intelligibility
- Loudspeaker for indoor use
- Certified according to EN 54-24: 2008

The in-ceiling loudspeakers of the DELFL 165/6 PP EN54 series are used together with the INDUSTRONIC communication and public address system. The speakers comply with the high safety requirements of EN 54-24: 2008 and are therefore ideal for use in voice alarm systems. The enclosed housing protects the loudspeaker against the ingress of dirt and dust from behind.

The power adjustment is carried out via different tapings on the primary side of the transformer.

### Mechanical data

• Housing	Metal
• Fire dome	Metal
• Diameter	Ø 220 mm (8 1/2")
• Mounting hole	Ø 198 mm to 210 mm (7 3/4" to 8 1/4")
• Installation depth	110 mm
• Cable entries	2 x 20 mm with rubber plugs
• Weight	Approx. 1.7 kg (approx. 3.8 lb)
• Color	White, RAL 9010
• Connection	Screw terminals
• Mounting	Ceiling mounting, spring mechanism

### Environmental requirements and standards

• Ambient temperature during operation	-20 °C to +60 °C (-4 °F to 140 °F)
• Relative humidity (non-condensing)	Max. 95 %
• Certification	EN 54-24: 2008

### Electrical data

• Rated power	6 W
• Transformer tapplings	100 V: 6 W / 3 W / 1.5 W / 0.75 W
• Sound pressure level 1 W, 1 m	97 dB +/- 3 dB
• Sound pressure level 6 W, 1 m	105 dB +/- 3 dB
• Effective frequency range	280 Hz to 20.000 Hz
• Dispersion angle -6 dB	1 kHz: 150°, 4 kHz: 60°

### Frequency diagram

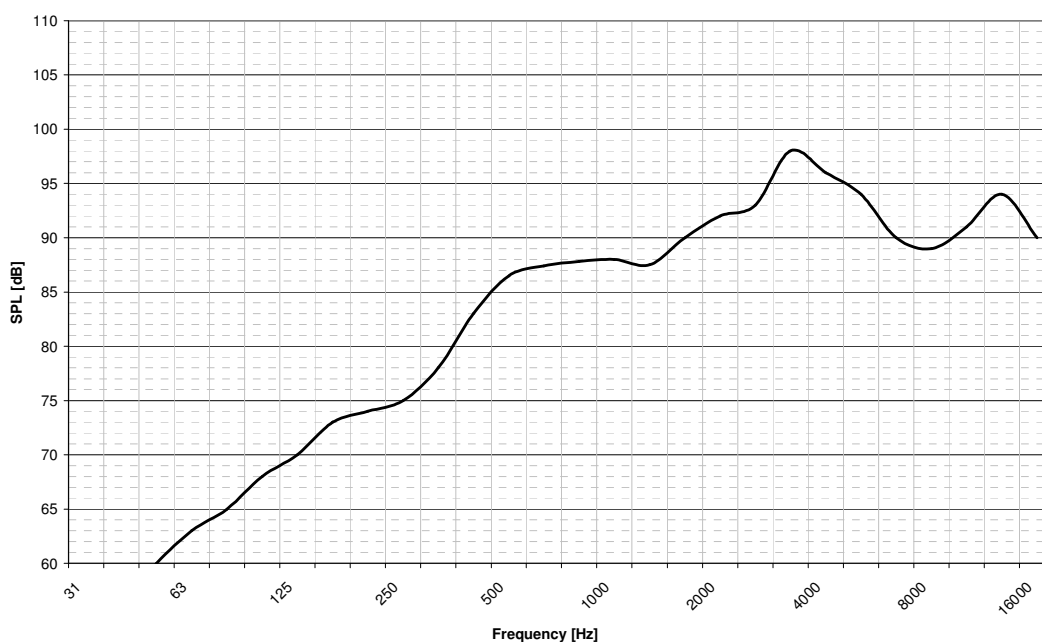

### Measurement conditions

Sound pressure level (SPL): 1 W / 1 m

Pink noise: 1/3 octave filter

### Output level related to distance

P <sub>max</sub> :	Level (dB) at	(-6 dB)	(-12 dB)	(-16 dB)	(-18 dB)	(-22 dB)	(-24 dB)	(-26 dB)	(-28 dB)
	6 W	1 m	2 m	4 m	6 m	8 m	12 m	16 m	20 m
105		99	93	89	87	83	81	79	77

## Polar diagram

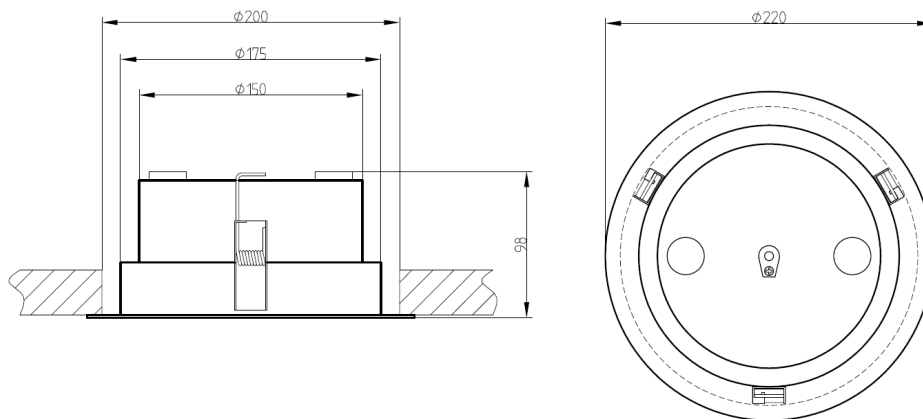
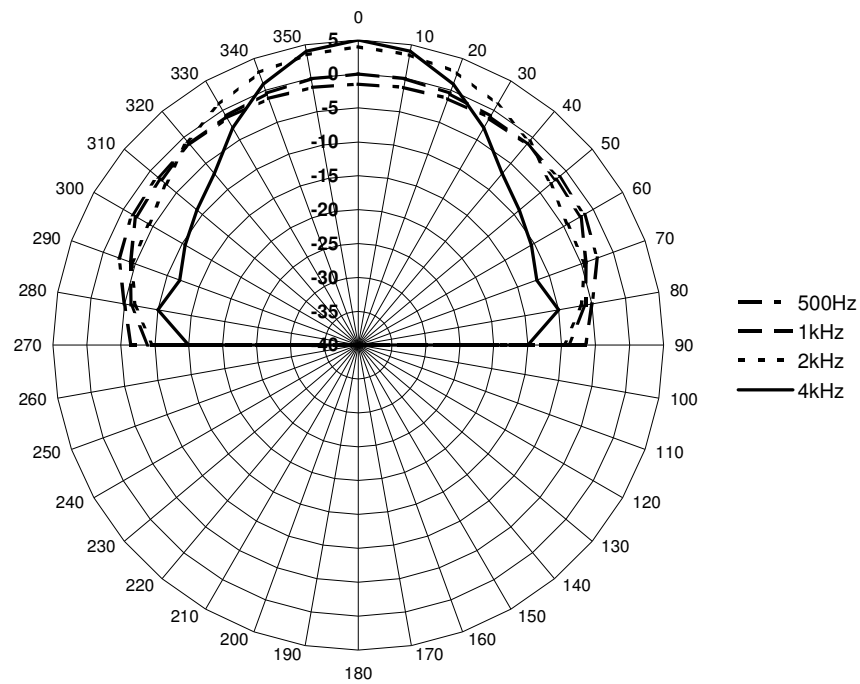

Figure 1: Dimensional drawing DELF 165/6 PP EN54

### INDUSTRONIC®

Industrie-Electronic GmbH & Co. KG  
 Carl-Jacob-Kolb-Weg 1  
 97877 Wertheim / Germany

Tel: +49 9342 871-0  
 Fax: +49 9342 871-565

info@industronic.de  
 www.industronic.com